

Module 6: Work, Play, Live

Exercise 1: What's up in my city?



Source:

<https://www.pexels.com/fr-fr/photo/photographie-a-plat-de-personne-touchant-l-ipad-argente-sur-la-carte-du-monde-graphique-a-cote-du-chapeau-noir-1051077/> by Element5 Digital

The best way to gather this information is to ask residents directly. To do this, let's create a [Google Form](#)!

If necessary, here is a [tutorial](#) on how to use Google Forms.

This questionnaire must address all the topics involved in our survey (work, leisure, business and services...). Here are some questions in order of themes that could be used in your questionnaire:

Work

- How difficult is it to find a job in your city?
- Why ?
- Do you work in the city you live in?
- What mode of transportation do you use to go to work?
- Do you have some suggestions to improve the work sector in your city?

Leisure

- How would you rate your city's recreational offerings?
- What leisure activities do you participate in?
- What are the big events in your city, such as fairs, concerts, festivals?
- Do you have some suggestions to improve them or create them?

This publication reflects the views of the authors; the Commission cannot be held responsible for any use which might be made of the information contained herein.

Meeting

- How difficult is it to make friends in your city?
- How do you meet new people in your city?
- Are there enough shared spaces in your city to meet people?
- If needed, do you have some suggestions to improve the situation?

Worship

- Does your city allow you to worship in good conditions?
- Do you have any suggestions?

Business & services

- Are the small local shops still functioning?
- What services are lacking?
- Do you have some suggestions?
- Once the Google Form is created, make it available online and disseminate it through your social media (Facebook, Twitter, etc.)
- Define a deadline to collect information. Then, since Google Form allows you to analyse the responses, you'll get an overview of the main issues faced by the residents.
- This survey could be shared with your city's decision makers and officials to meet the residents' needs if possible and feasible or at least make them aware of these problems.
- To give more impact to this survey, you could create an infographic with Canva using data collected.

Create an infographic on Canva.

1. Go to www.canva.com
2. Create an account if necessary

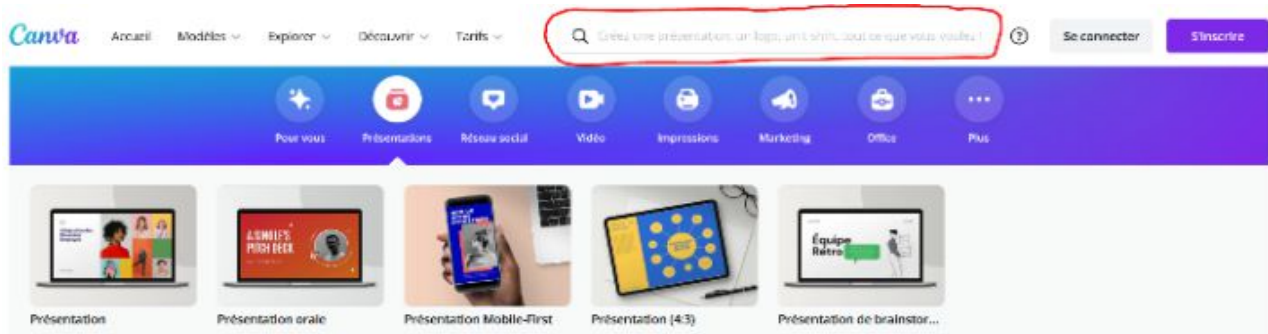

3. Type in the research box "Infographic" (see picture above)
4. The website should make 2 suggestions: Science Infographic and Art Infographic. Both are suitable for your activity, the choice will depend on your project.

This publication reflects the views of the authors; the Commission cannot be held responsible for any use which might be made of the information contained herein.

- Then, you will be redirected to this page with templates on the left. Choose the visual according to your preferences.

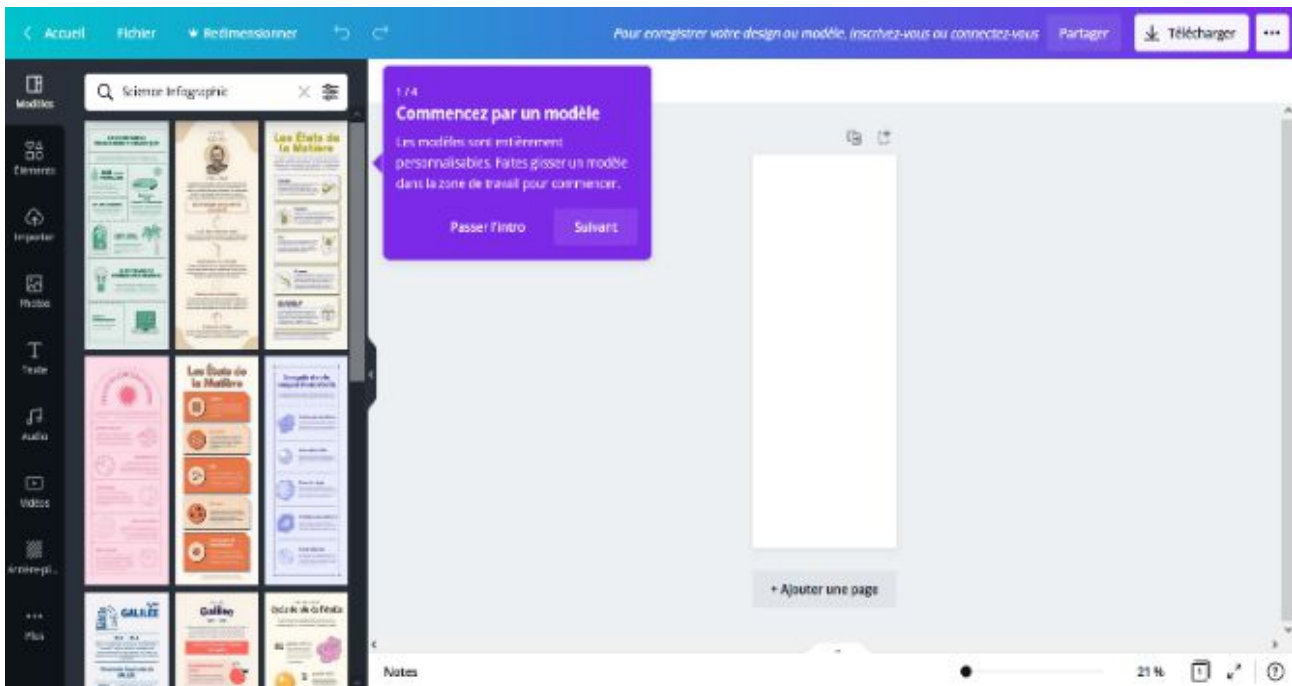

- Use the data collected in the online survey, you will adapt them visually in the Infographic.
- Canva will help you in this creative process. If you are a beginner, make it simple, choose a template provided by the website and replace the content with your data. Be creative! But keep in mind that this infographic should visually represent what the data has highlighted about the identified topics or issues. Visuals have more impact on the general public than only numbers.